



Enriching Lives

KIRLOSKAR BROTHERS LIMITED

Let's celebrate the spirit

Present

iCP Series Centenary Pumps

The experience of a century, in service of the chemical industry



1nnovation delivers **0** leakage and **0** maintenance
... a tribute to the centenary of a movement called Kirloskarvadi!



Kirloskarvadi Centenary Saluting The Spirit

100 years ago, when Laxmanrao Kirloskar, one of the founding fathers of the Indian industry, set his foot on a stretch of barren land, it might have been a small step for him... but it was a giant leap for India's emergence as an industrial powerhouse. Because, there he established an industrial township called Kirloskarvadi that was to later evolve into a movement, effecting powerful transformations in millions of lives across the Globe.

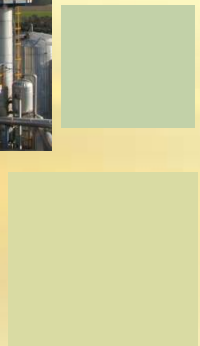
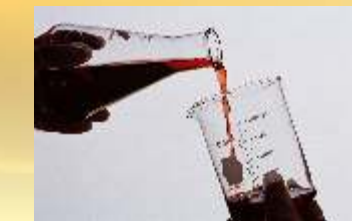
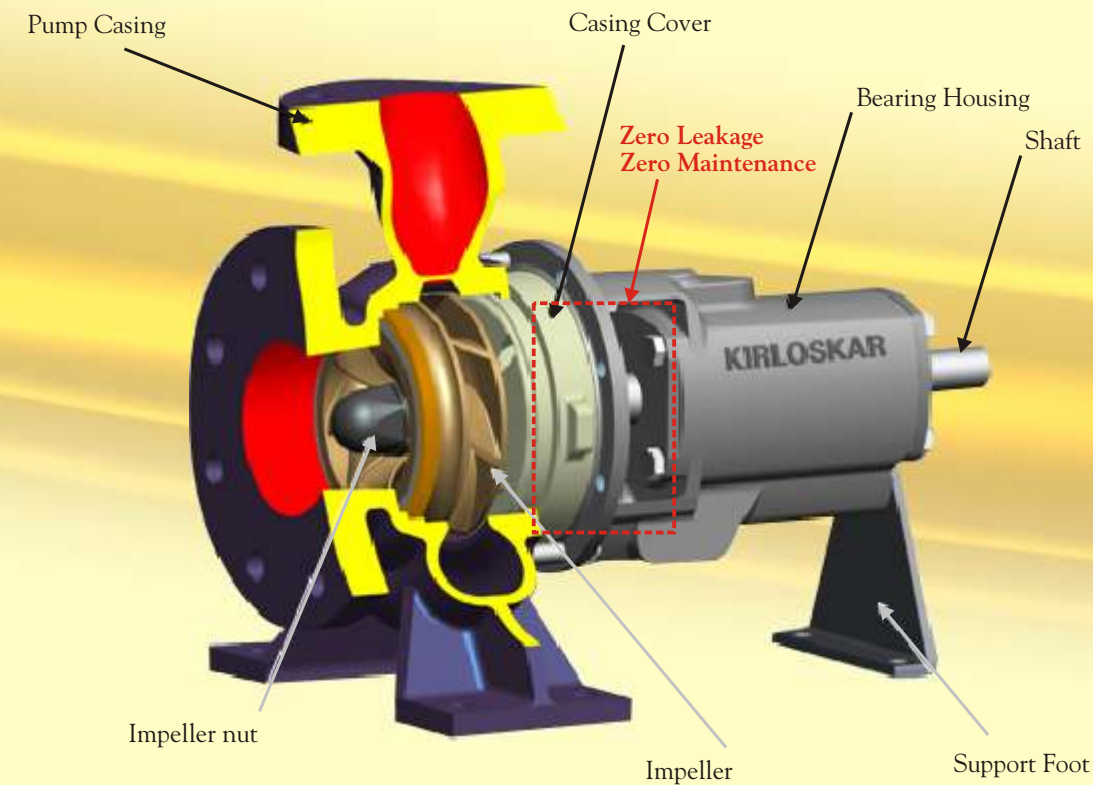

In Pursuit of Innovation

Kirloskar Brothers Limited are the proud torchbearers of this legacy and have stayed ahead of the leading edge of technology by leveraging the power of innovation.

i-mission is an initiative at KBL, that focuses on continuous user interaction to understand their specific needs and then unleashing the power of innovation to deliver the right solutions.



iCP Series - The Essence of A Century of Engineering Excellence

Celebration, in the best Kirloskar tradition, is in achieving the next level of excellence! True to this tradition, KBL is proud to present the new **iCP Series Centenary Pumps** for the chemical industry. Being totally seal-less and gland-less, the iCP series pumps deliver high efficiency with 0 leakage and 0 maintenance... the perfect way to salute the 100 years that have gone by and to welcome the next 100 years of truly special achievements.

(Patent Pending)

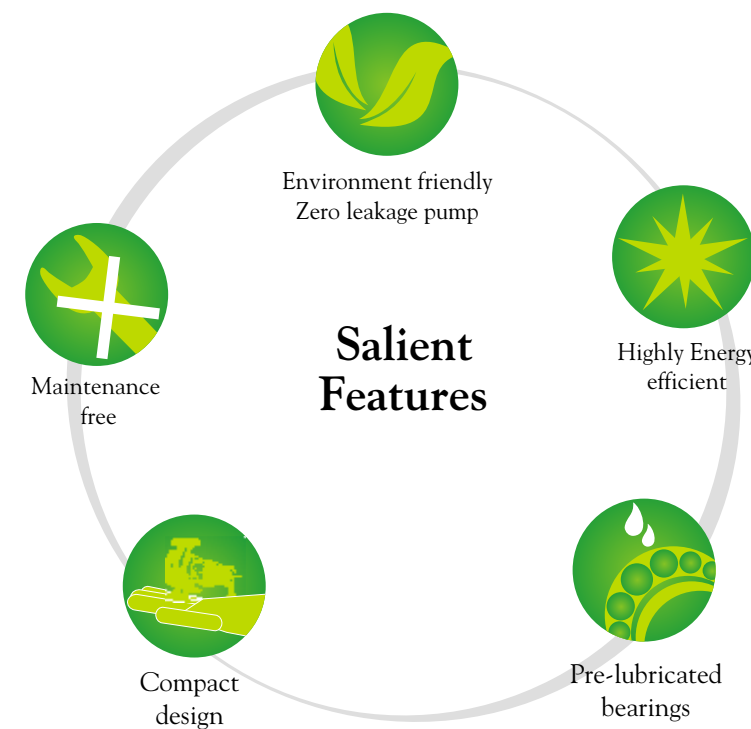

- Pump without mechanical seal & without gland packing arrangement
- Sealing/flushing water not required
- Self venting design
- Pump with back pull out design
- Conforming to ISO 2858 standard
- Pump is sturdy yet light in weight
- Shaft is fully protected from liquid
- Widely interchangeable components
- Models available in 1450 & 2900 RPM

Applications

iCP Pumps suitable for :

- Light chemicals like caustic soda, weak acids etc.
- Food & Beverage industries (Sugar, Vegetable oils, etc.)
- Hot water, Brine, DM water, Lime water, etc.

Performance Range

- At 1450 rpm
Rate of flow [Q] up to 180 m³/hr
Head [H] up to 55 m
- At 2900 rpm
Rate of flow [Q] up to 150 m³/hr
Head [H] up to 85 m
- Temperature up to 95 °C

Material of Construction

MOC CODE	ALL CI	Br. FITTED	ALL CAST STEEL	CF8M FITTED	ALL CF8M
COMPONENT	(01)	(02)	(10)	(11)	(72)
CASING	CI	CI	CAST STEEL	CI	CF8M
CASING RING	CI	CI	CA15	CI	CF8M
IMPELLER	CI	BRONZE	CAST STEEL	CF8M	CF8M
SHAFT	40C8	40C8	40C8	40C8	SS316
SHAFT SLEEVE	SS410H	SS410H	SS410H	SS410H	SS410H

NOTE : H denotes hardened. For other material requirement Refer to Engineering.

iCP Family range 1450 RPM

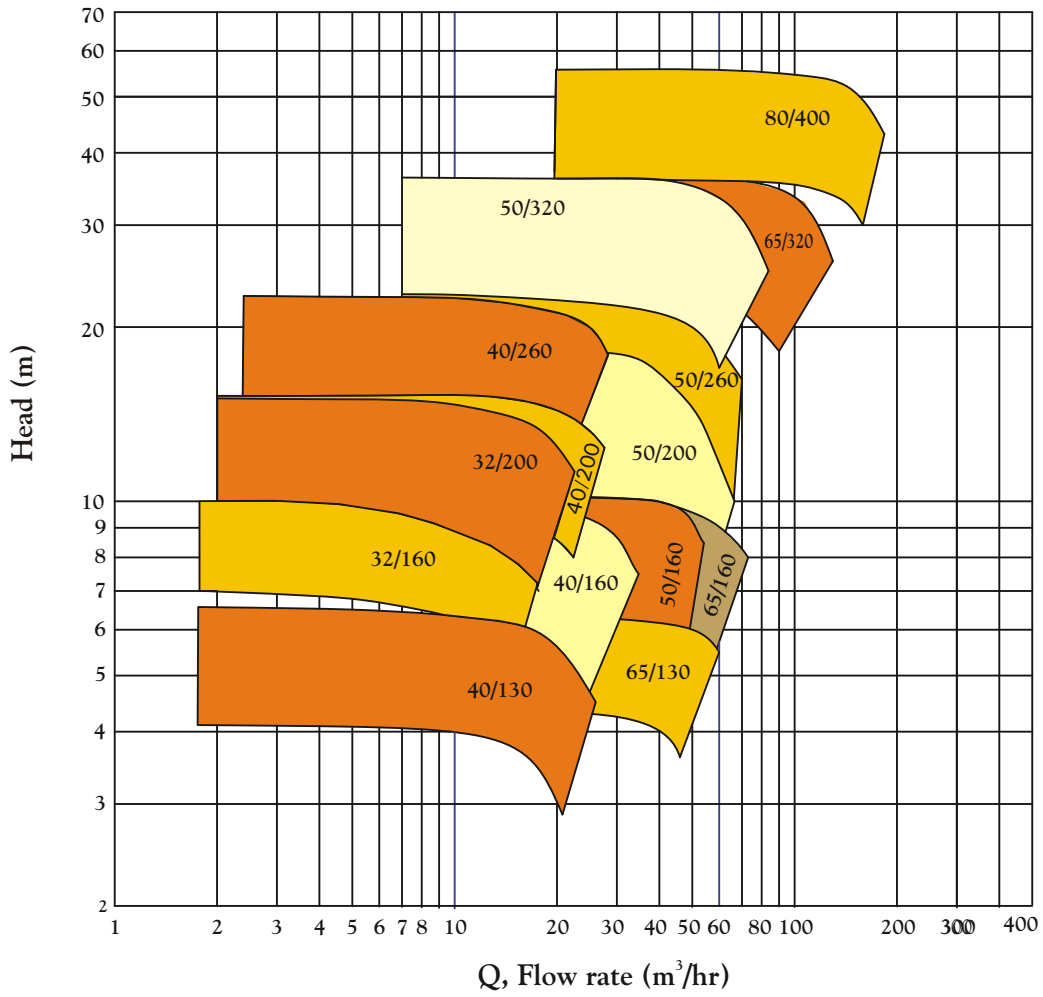

iCP Family range 2900 RPM

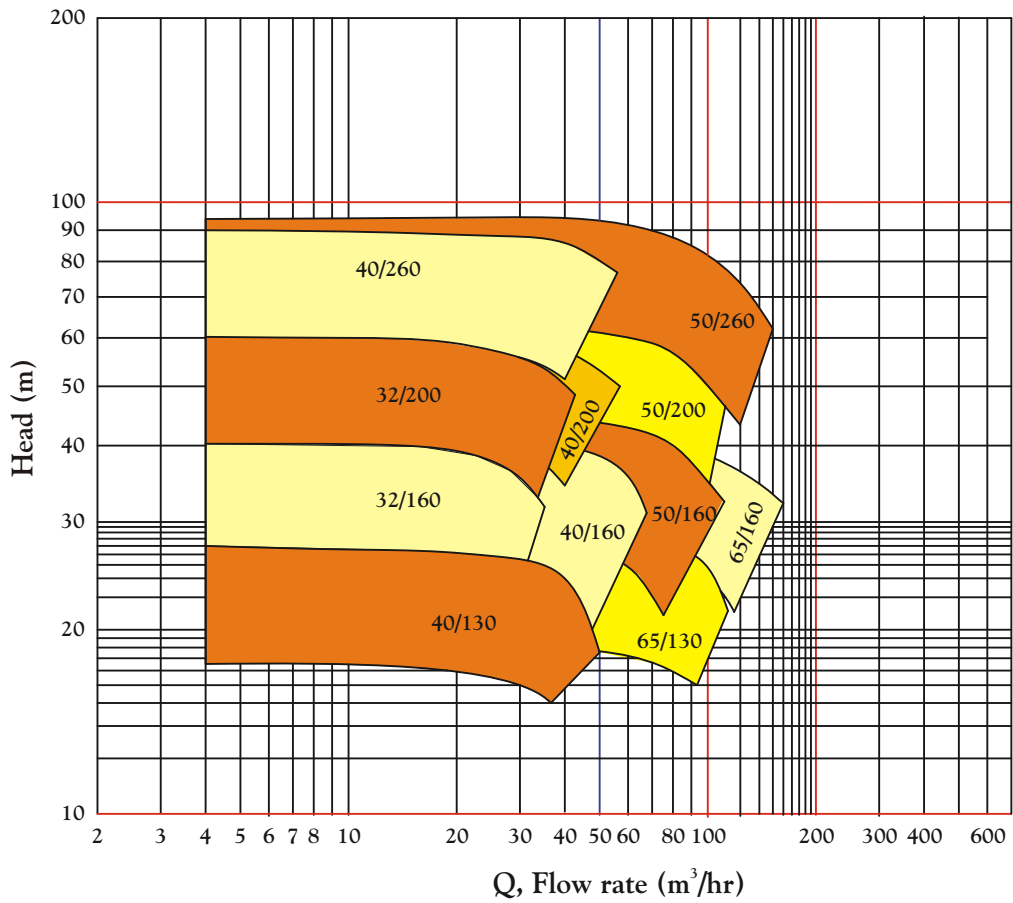

General Outline Drawing

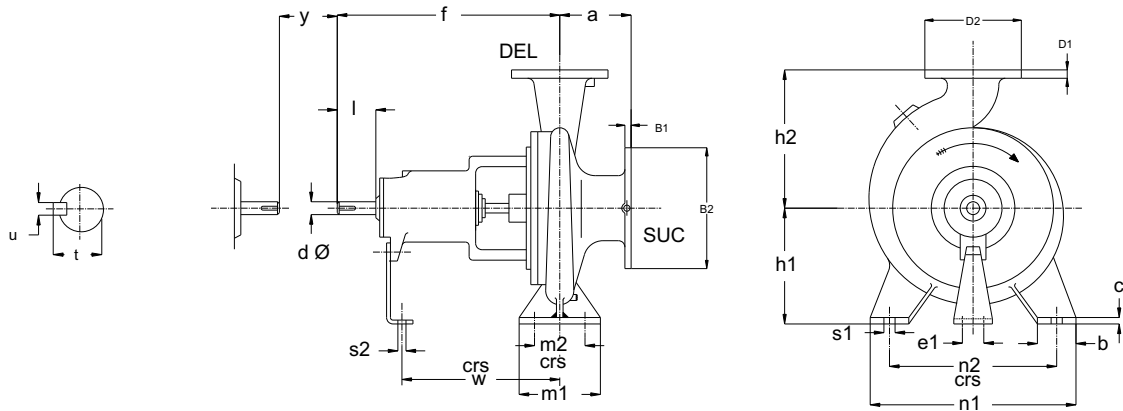

PUMP SIZE	DRIVING UNIT	PUMP DIMENSIONS										FOOT DIMENSIONS								SHAFT END						
		DEL	SUC	a	f	h1	h2	B1	B2	D1	D2	b	c	m1	m2	n1	n2	w	s1	s2	e1	d	l	t	u	y
32/160	30	32	50	80	385	132	160	22	165	20	140	50	14	100	70	240	190	285	14	15	110	24	50	27	8	100
32/200						160	180	22	165	20	140					240	190									
40/130		40	65	100		112	140	24	185	20	150					210	160									
40/160						132	160	24	185	20	150					240	190									
40/200						160	180	24	185	20	150					265	212									
50/160						50	80	100	160	180	24					200	22									
65/130	40A	40	65	100	500	180	225	24	185	20	150	65	14	125	95	320	250	370	14	15	110	32	80	35	10	140
40/260						50	80	125	160	200	24	200		22	165	50	100									
50/200		50	100	100		180	225	24	200	22	165	320		250												
50/260						160	200	26	220	24	185	280		212												
65/160						180	225	24	200	22	165	65		125	95	345	280									
50/320						40B	50	80	125	500	225	280		24	200	22	165									
65/320	50	65	100	125	530	225	280	26	220	24	185	80	16	160	120	400	315	370	18	15	110	42	110	45	12	140
80/400		80	125			280	355	28	250	24	200					435	355									

As we are constantly endeavouring to improve the performance of our products/ equipment, we reserve the right to make alterations from time to time and as such our products/ equipment may differ from that detailed in this publication. For latest information you may get in touch with our Regional Sales Offices.



Pumps | Valves | Motors | Hydro Turbines | Turnkey Projects

KIRLOSKAR BROTHERS LIMITED

Corporate & Marketing Office : "Yamuna", Survey No. 98 / 3 to 7 Baner, Pune - 411 045 (India) • Phone: +91 - 20 - 2721 4444 • E-mail : kblin@kbl.co.in • Web Site : www.kbl.co.in

Regional Sales Offices: India: Ahmedabad, Bangalore, Bhubaneswar, Kolkata, Chennai, Jaipur, Kochi, Lucknow, Mumbai, Nagpur, New Delhi, Pune, Ranchi, Secunderabad
Overseas: Ajman, Cairo, Johannesburg, Nairobi, Phnom Penh, Miami, Vientiane, Bangkok, Amsterdam, Dakar